

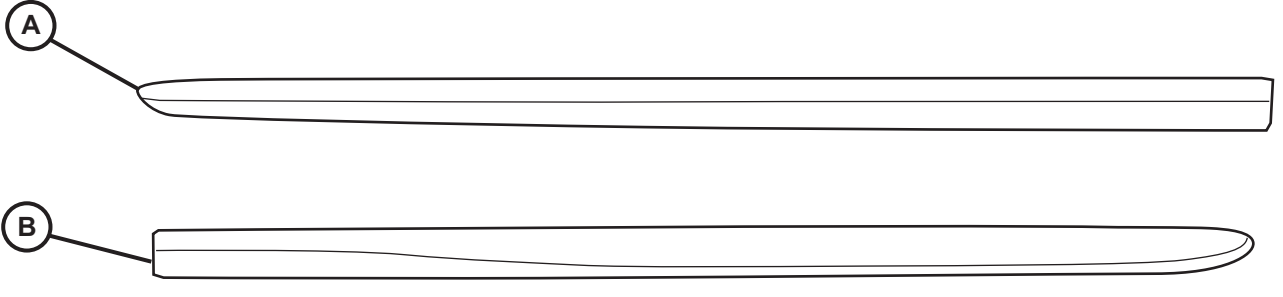

CHRYSLER PACIFICA BODYSIDE MOLDING

www.mopar.com

DRIVER SIDE



PASSENGER SIDE

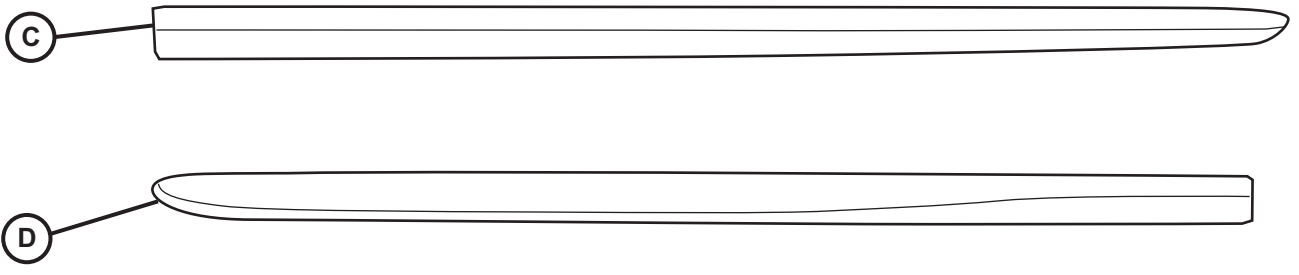

Temperature range: 97°F / 35°C to 52°F / 15°C. A warning symbol shows a circle with a diagonal line over water droplets, indicating no moisture.

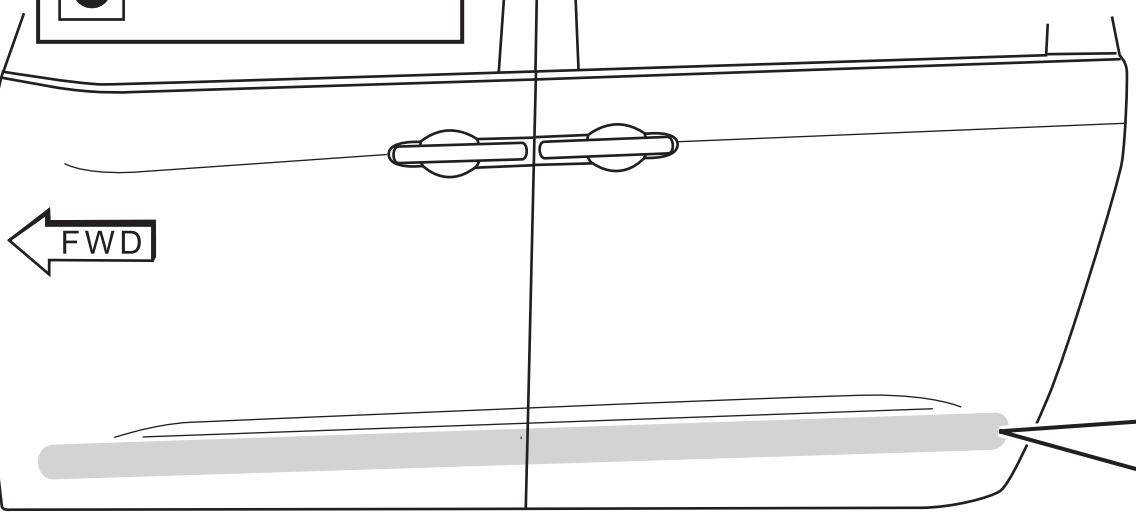
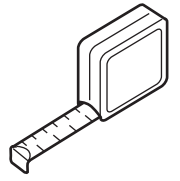
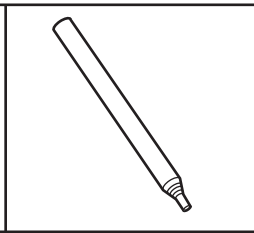
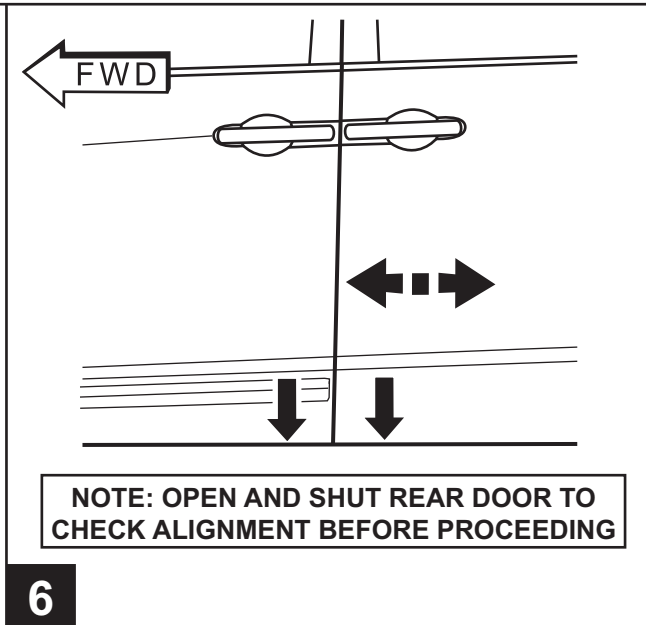
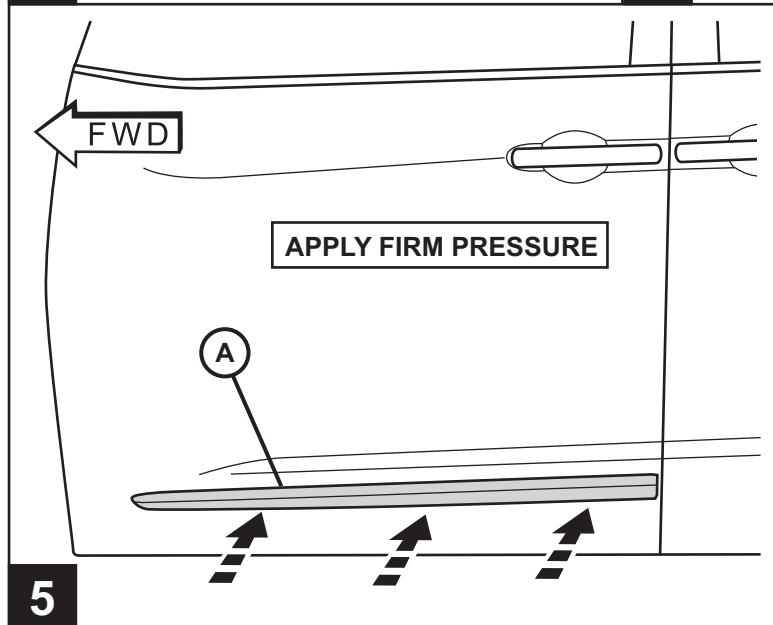
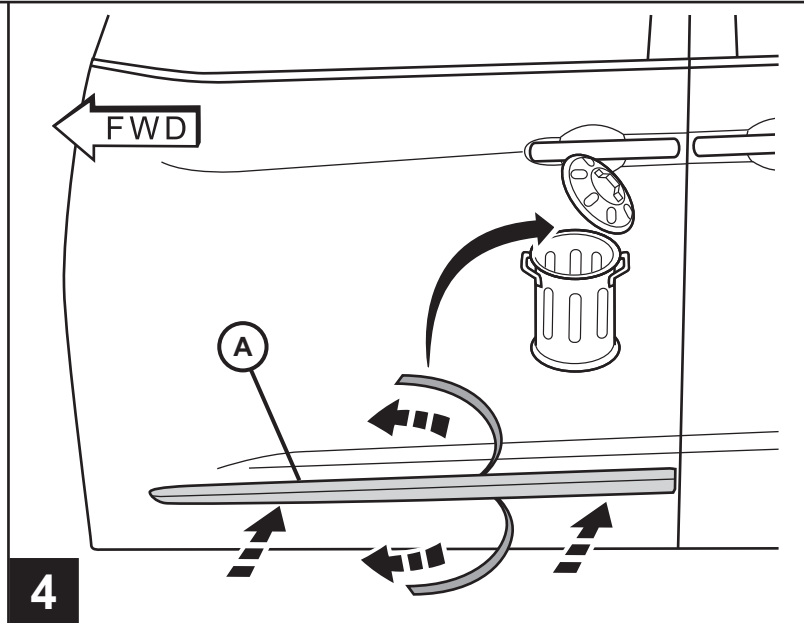
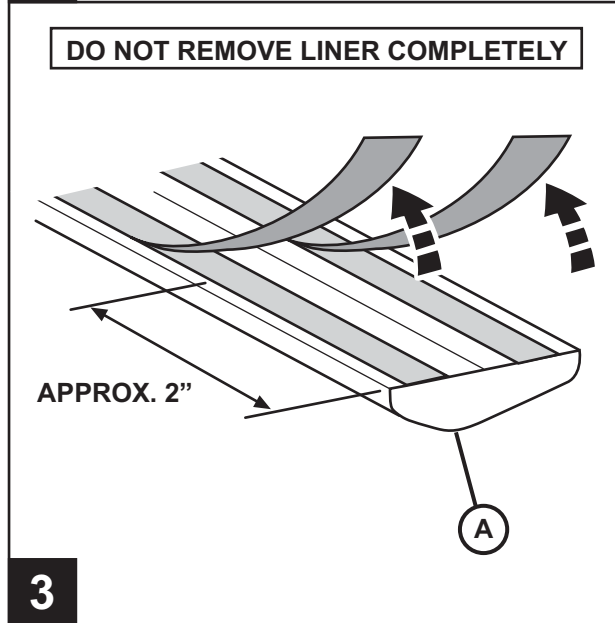
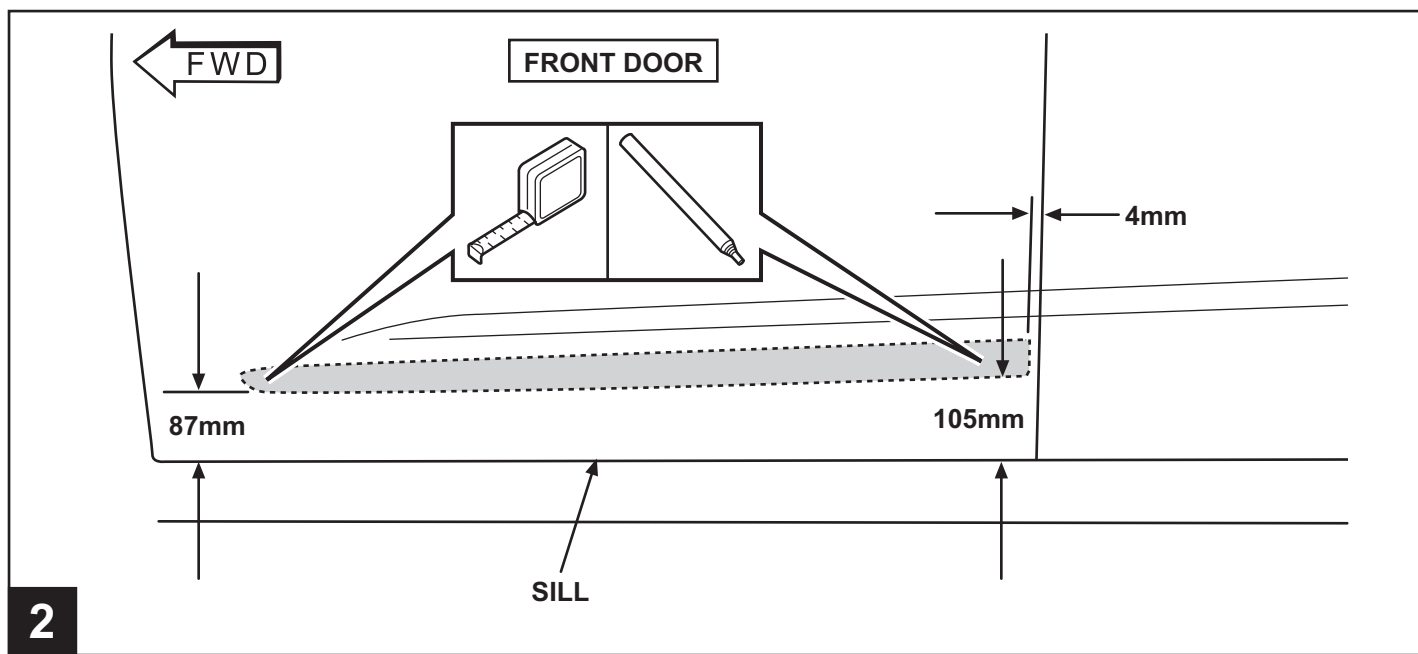

Diagram showing a sponge, a bucket of adhesive, and an ALCOHOL PAD, indicating the preparation steps for the molding.

1



FWD

7.5mm

SLIDING DOOR

130mm

SILL

NOTE: USE A STRAIGHT EDGE TO ALIGN THE REAR MOUNTING LOCATION WITH THE FRONT

7

DO NOT REMOVE LINER COMPLETELY

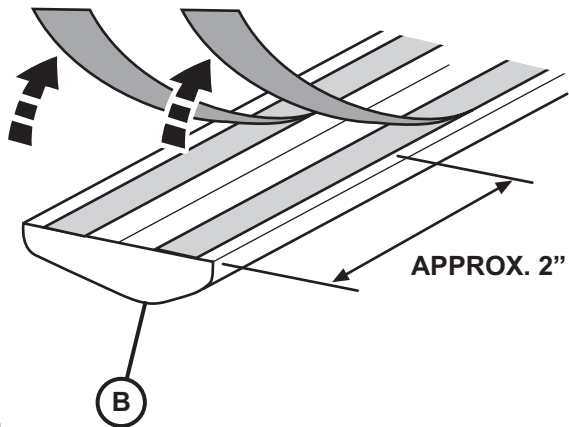

8

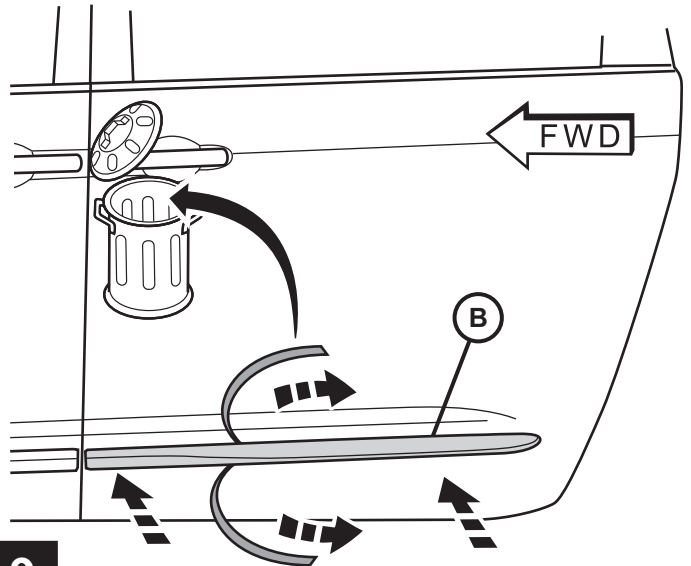

9

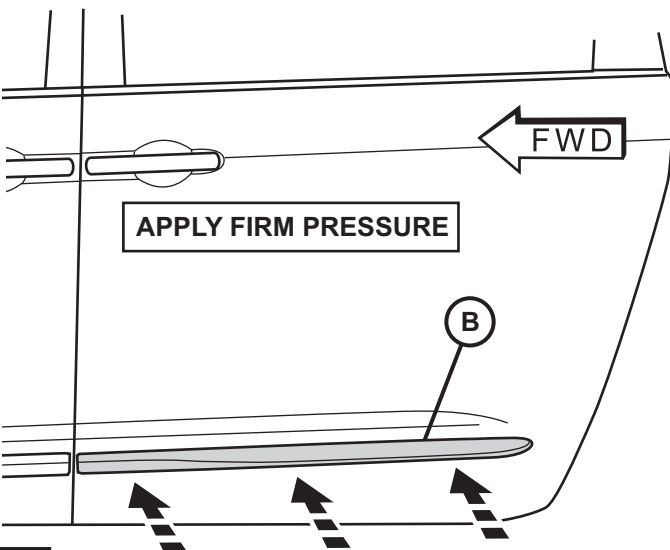

10

REPEAT STEPS 1 THROUGH 10 ON PASSENGER SIDE OF VEHICLE USING PARTS (C) AND (D)

11

CAUTION!

DO NOT DRIVE VEHICLE THROUGH AUTOMATIC OR HIGH PRESSURE CAR WASH FOR 72 HOURS AFTER INSTALLATION.